

RESOLUTION AMENDING THE LEBANON SOUTH SANTIAM ENTERPRISE ZONE INCLUDING PORTIONS OF LINN COUNTY, CITY OF ALBANY, CITY OF MILLERSBURG, AND CITY OF TANGENT FOR THE ECONOMIC BENEFIT OF THESE CITIES AND LINN COUNTY

WHEREAS, in 2007, the City of Lebanon, City of Albany, City of Millersburg, and Linn County successfully applied for an enterprise zone, which was designated as the South Santiam Enterprise Zone by the Director of the Oregon Community and Economic Development Department; and

WHEREAS, this Enterprise Zone and the tax exemptions that it offers for new investments in plant and equipment by eligible business firms are critical elements of local efforts to increase employment opportunities, to raise local incomes, to attract investments by new and existing businesses, and to secure and diversify the local economic base; and

WHEREAS, the name of the amended enterprise zone will remain the South Santiam Enterprise Zone in recognition of its original sponsors; and

WHEREAS, the City of Lebanon, City of Albany, City of Millersburg, and Linn County are currently sponsoring governments of the South Santiam Enterprise Zone and will remain cosponsors; and

WHEREAS, officials of the City of Albany, City of Lebanon, City of Millersburg, and Linn County are agreed in requesting an amended zone that would add the area indicated in attachment Exhibit A, which contains assessors tax lot designations, such that the amended Enterprise Zone would consist of the original Lebanon Enterprise Zone plus previous additions plus the listed property; and

WHEREAS, public meetings were held in each jurisdiction to hear the response of the citizens to the proposed change in the South Santiam Enterprise Zone requested herein; and

WHEREAS, notices were sent to the appropriate local taxing districts of the area being added.

NOW, THEREFORE, BE IT RESOLVED that:

1. The City of Lebanon, City of Albany, City of Millersburg, and Linn County will remain cosponsors of the South Santiam Enterprise Zone;
2. The City of Lebanon, City of Albany, City of Millersburg, and Linn County request amendments to the South Santiam Enterprise Zone area as shown in attachment Exhibit B;
3. The name of the expanded enterprise zone will remain the South Santiam Enterprise Zone;
4. The Albany-Millersburg Economic Development Corporation may co-manage the expanded South Santiam Enterprise Zone's added property with the City of Lebanon as agreed under a separate agreement; and
5. The Albany-Millersburg Economic Development Corporation as the enterprise zone expansion requesting organization on behalf of Linn County is hereby authorized to prepare and submit technical memoranda to Business Oregon (the Oregon Economic and Community Development Department), along with this resolution and other necessary documents, verifying that the requested expansion of the South Santiam Enterprise Zone complies with the requirements of ORS 285C.115, so that the request herein may be approved by order of the Director of the Oregon Economic and Community Development Department.

DATED AND EFFECTIVE THIS 25<sup>TH</sup> DAY OF FEBRUARY 2013.

ATTEST:

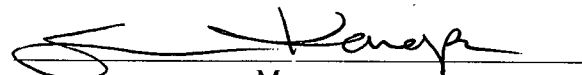

\_\_\_\_\_  
Mayor

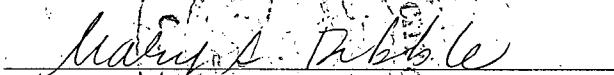

\_\_\_\_\_  
City Clerk

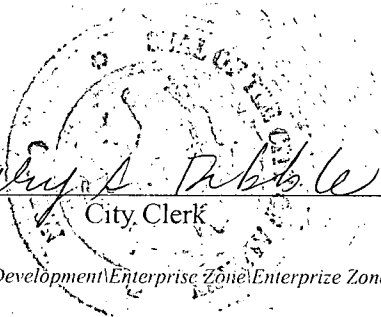

EXHIBIT A

South Santiam Enterprise Zone  
Amendment 2013

Exhibit A includes the following area calculations and Enterprise Zone Map, page 2.

New Enterprise Zone Area:

8976.32	Total Acres*
14.03	Square Miles
15	Maximum Zone Area Allowed

\*Note: A listing is Available from the John Pascone, Zone Manager  
and is on file with the Linn County GIS Dept. (it is Over 13,000 pages)

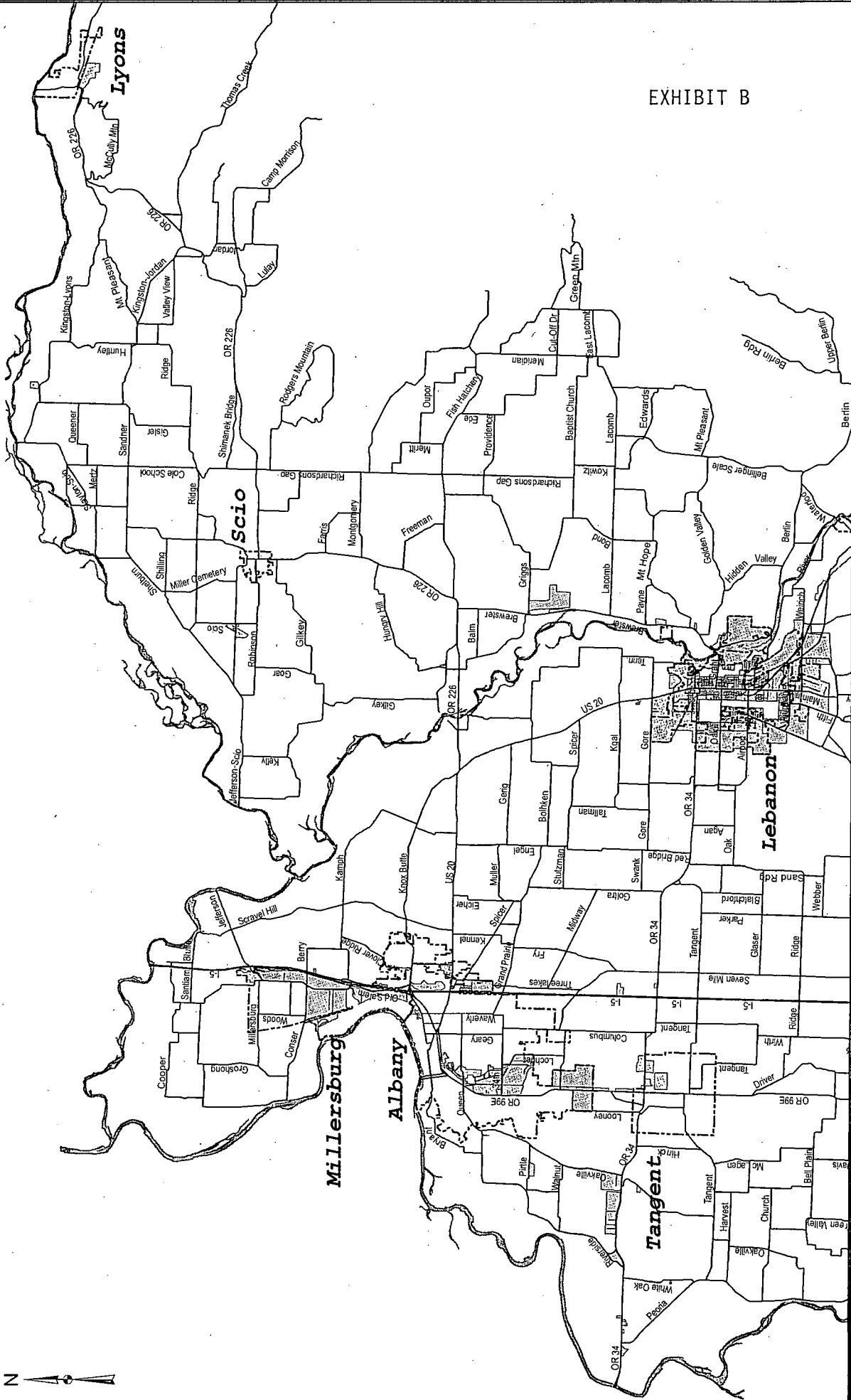
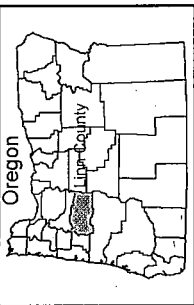
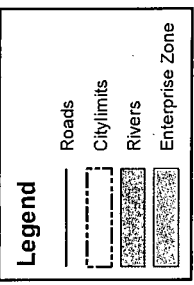

EXHIBIT B



South Santiam Enterprise Zone - Linn County, Or



Linn County Disclaimer

This map was created for display purposes only. The map plus the Linn County digital data used to produce the map are subject to errors and/or omissions. Linn County disclaims any liability as to the completeness or accuracy of the map and data displayed.

01/26/2013

