

RESOLUTION NO. 5539

A RESOLUTION ACCEPTING THE FOLLOWING RIGHT-OF-WAY DEDICATION:

Grantor

Glorietta Bay, LLC

Purpose

Right-of-way along the North Albany Middle School Driveway required for the construction of a traffic signal and turn lanes at the entrance to North Albany Middle School.

NOW, THEREFORE, BE IT RESOLVED by the Albany City Council that it does hereby accept this right-of-way dedication deed.

DATED AND EFFECTIVE THIS 12TH DAY OF DECEMBER 2007.

  
Council President

ATTEST:

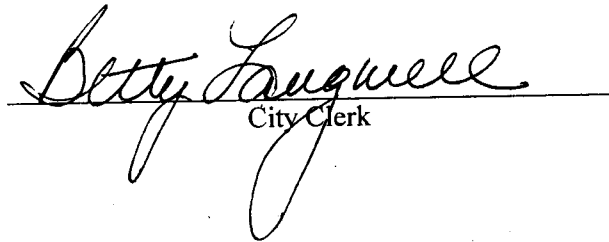
  
City Clerk

**RECORDING COVER SHEET (Please Print or Type)**

This cover sheet was prepared by the person presenting the instrument for recording. The information on this sheet is a reflection of the attached instrument and was added for the purpose of meeting first page recording requirements in the State of Oregon, ORS 205.234, and does NOT affect the instrument.

BENTON COUNTY, OREGON **2008-434155**  
DE-EAS **03/03/2008 01:11:42 PM**  
Cnt=1 Stn=5 MR  
\$30.00 \$11.00 \$10.00 \$15.00 **\$66.00**



00154424200804341550060067  
I, James V. Morales, County Clerk for Benton County, Oregon, certify that the instrument identified herein was recorded in the Clerk records.



James V. Morales - County Clerk

**AFTER RECORDING RETURN TO:**

✓ City of Albany Recorder

PO Box 490

Albany, OR 97321

All Tax Statements Should Be Sent To:

Government Agency - Exempt

1. Name/Title of Transaction - by ORS 205.234 (a)

RIGHT OF WAY DEDICATION

2. Grantor/Direct Party - required by ORS 205.125(1)(b) and ORS 205.160

Glorietta Bay, LLC

3. Grantee/Indirect Party - required by ORS 205.125(1)(a) and ORS 205.160

City of Albany

4. True and Actual Consideration (if there is one), ORS 93.030

\$.00

## **RIGHT-OF-WAY DEDICATION**

KNOW ALL MEN BY THESE PRESENTS, that Glorietta Bay, LLC, an Oregon Limited Liability Company, hereinafter referred to as Grantor, hereby dedicates to the City of Albany, a Municipal Corporation, hereinafter called "City" for right-of-way purposes, portions of that real property situated in Benton County, Oregon, conveyed to Grantors by deed recorded on Microfilm No. 240247-98, Benton County deed records, and being more particularly described as follows:

A piece of land in Section 36 of Township 10 South in Range 4 West of Willamette Meridian, City of Albany, Benton County, Oregon as described in the attached Exhibit A, as shown on the attached map labeled Exhibit B and the attached vicinity map labeled Exhibit C.

The Grantor covenants that they are lawfully seized and possessed of the real property above described and that they have a good and lawful right to convey it or any part thereof and that they will forever warrant and defend the same against all persons who may lawfully claim the same.

The right-of-way dedicated herein is in consideration of \$1.00, receipt of which is acknowledged by the Grantor, and in further consideration of the public improvements to be placed upon said property and the benefits grantors may obtain therefrom.

IN WITNESS WHEREOF, the Grantor has hereunto fixed their hand and seal the day and year written below.

**GRANTOR:**

Glorietta Bay, LLC

  
\_\_\_\_\_  
Scott Lepman, Managing Member

STATE OF OREGON )  
County of Linn ) ss.  
City of Albany )

The instrument was acknowledged before me this  
3rd day of December, 2007,  
by Scott Lepman, Managing Member, as a  
representative of Glorietta Bay, LLC.

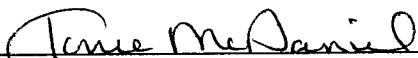
  
\_\_\_\_\_  
Notary Public for Oregon  
My Commission Expires: Aug 4, 2011

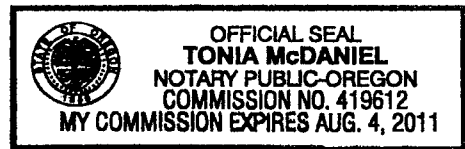

**CITY OF ALBANY:**

STATE OF OREGON )  
County of Linn ) ss.  
City of Albany )

I, Wes Hare, as City Manager of the City of Albany, Oregon, pursuant to Resolution Number 5539 do hereby accept on behalf of the City of Albany, the above instrument pursuant to the terms thereof this 2 day of December, 2007.

  
\_\_\_\_\_  
City Manager

ATTEST:

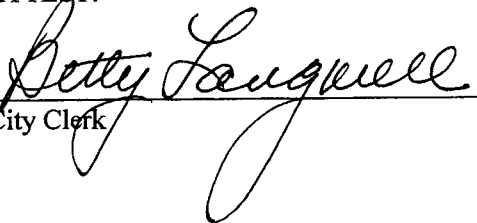
  
\_\_\_\_\_  
City Clerk

## EXHIBIT "A"

A certain portion of that Tract of land as the same is described in the deed recorded on Microfilm No. 240247-98, Deed Records of Benton County, Oregon; said portion being more particularly described as follows:

Beginning at the point of intersection of the south line of said Tract with the East right of way line of North Albany Road (County Road 14400), thence N 03°40'40" W on said East line a distance of 49.68 feet, thence leaving said East line S 50°34'23" E a distance of 45.24 feet to a point distant 9.00 feet northerly from the south line of said Tract, thence N 70°26'00" E parallel with said south line and distant 9.00 feet therefrom, a distance of 133.17 feet, thence S 65°26'26" E a distance of 12.93 feet to the south line of said Tract, thence S 70°26'00" W on said south line a distance of 179.35 feet to the East right of way line of said North Albany Road and the Point of Beginning.  
Containing 2227 square feet.

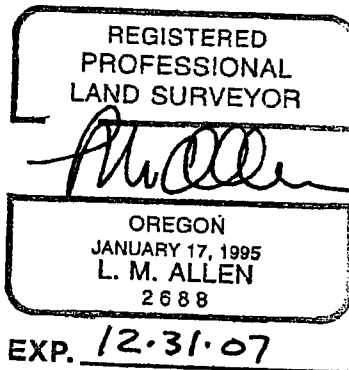

NORTH ALBANY ROAD

M-240247-98

S 65°26'26" E - 12.93'

N 03°40'40" W - 49.68'

S 50°34'23" E - 45.24'

9.00'

N 70°26'00" E - 133.17'

S 70°26'00" W - 179.35'

BOOK 189, PAGE 343

BOOK 126, PAGE 588



SCALE: 1" = 30'

REGISTERED  
PROFESSIONAL  
LAND SURVEYOR

OREGON  
JANUARY 17, 1995  
L. M. ALLEN  
2688

RENEWAL 12/31/2007



**PacWest Engineering**  
1530 Ninth Avenue SE  
Albany, OR 97321  
Phone (541) 926-7634  
Fax (541) 926-7539

DWG: 05-066.DWG  
DATE: 8/7/06  
PROJECT: 05-066

# EXHIBIT C

10SO4W36DD00600

North Albany Road ROW  
Dedication for Traffic  
Signal at entrance to  
North Albany Middle School



Geographic Information Services

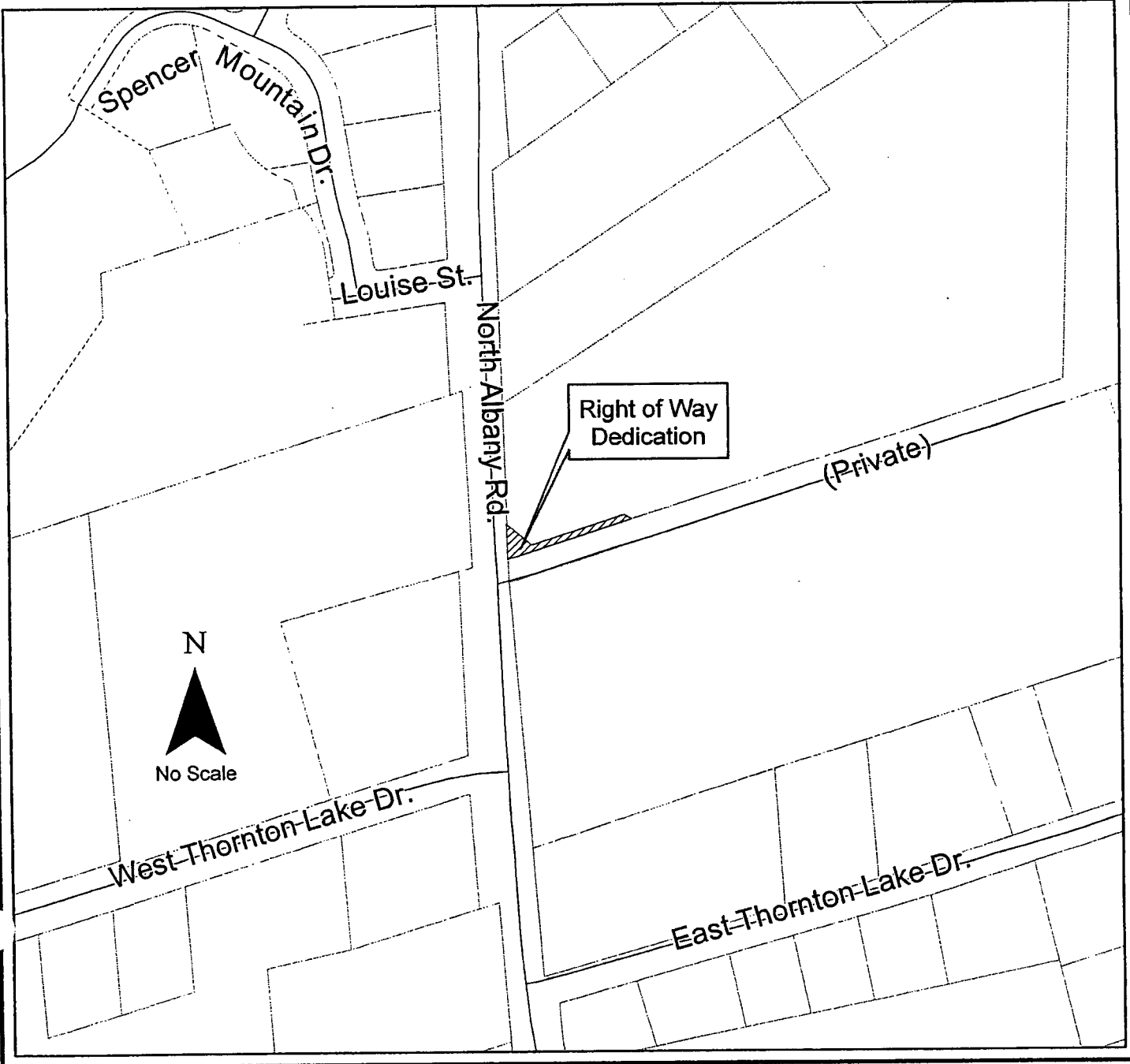
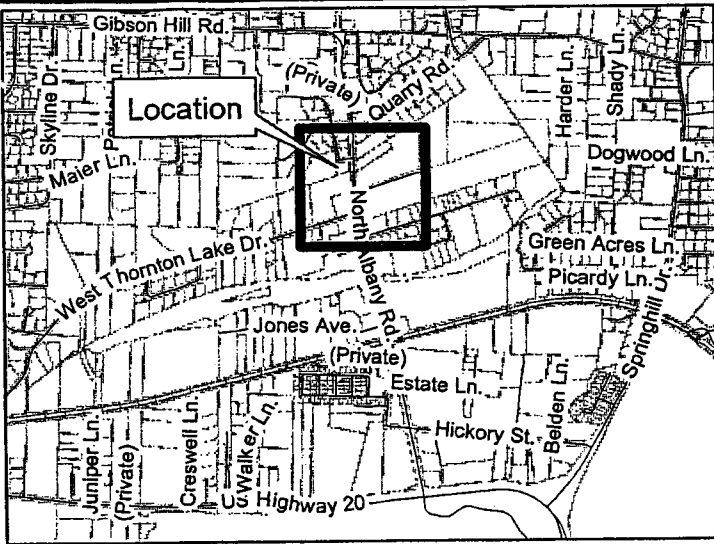

Resolution No. 5539

Recorded Document Recorder File No. 5046