

RESOLUTION NO. 5024

A RESOLUTION ACCEPTING THE FOLLOWING RIGHT-OF-WAY DEDICATION:

Grantor

Purpose

BERE LLC

Dedication Deed for street and utility purposes for
Clover Ridge Road right-of-way.

NOW, THEREFORE, BE IT RESOLVED by the Albany City Council that it does hereby accept this right-of-way dedication deed.

BE IT FURTHER RESOLVED that this resolution shall take effect immediately upon passage by the Council and approval by the Mayor.

DATED AND EFFECTIVE THIS 11TH DAY OF AUGUST 2004.



Mayor

ATTEST:



City Clerk

DEDICATION DEED

KNOW ALL MEN BY THESE PRESENTS, that Bere LLC, hereinafter referred to as the Grantor, does dedicate to the City of Albany for street and utility right-of-way purposes, all that real property situated in Linn County, State of Oregon, described as follows:

A 1,103 square foot strip of land in Section 4 of Township 11 South in Range 3 West of Willamette Meridian, City of Albany, Linn County, Oregon as described in the attached Exhibit A and as shown on the attached map labeled Exhibit B.

and covenants that the Grantor is the owner of the above described property free of all encumbrances save and except reservations in patents and easements of record, and will warrant and defend the same against all persons who may lawfully claim the same.

The deed granted herein is in consideration of \$4,191.40, receipt of which is acknowledged by the Grantor, and in further consideration of the public improvements to be placed upon said property and the benefits grantors may obtain therefrom. Nothing herein shall reduce or limit grantors obligation to pay any costs or assessments which may result from the improvements.

IN WITNESS WHEREOF, the Grantors have thereunto affixed their signatures this 13th day of July, 2004.

GRANTOR: BERE LLC

[Signature]
Gary Betts / Manager Member

[Signature]
Rynthia Renoud / Managing Member

STATE OF OREGON)
County of Linn) ss.
City of Sweet Home

STATE OF OREGON)
County of Linn) ss.
City of Lebanon

The foregoing instrument was acknowledged before me this 13th day of July, 2004, by Gary Betts, as his voluntary act and deed.

The foregoing instrument was acknowledged before me this 12 day of July, 2004, by Rynthia Renoud, as her voluntary act and deed.

[Signature]
Notary Public for the State of Oregon
My Commission Expires: 5-14-07

[Signature]
Notary Public for the State of Oregon
My Commission Expires: Aug 25, 2006

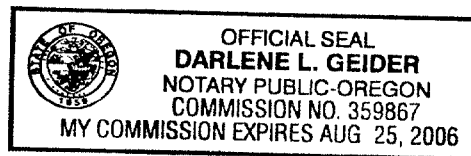
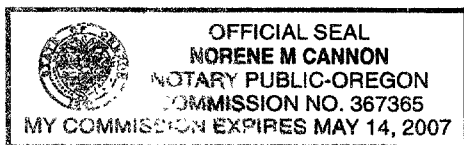

Return to: City of Albany - Recorder
P.O. Box 490, Albany, OR 97321

CITY OF ALBANY:

STATE OF OREGON)
County of Linn) ss.
City of Albany)

I, Steve Bryant as City Manager of the City of Albany, Oregon, pursuant to Resolution Number 5024 do hereby accept on behalf of the City of Albany, the above instrument pursuant to the terms thereof this 11th day of August, 2004.

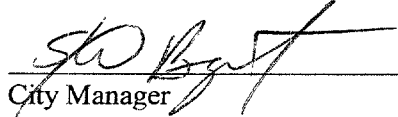

City Manager

ATTEST:

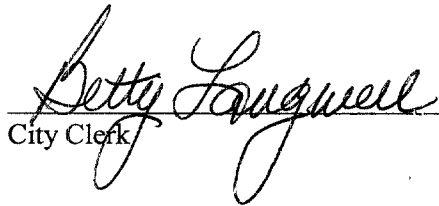

City Clerk

K & D ENGINEERING, Inc.

Engineers • Planners • Surveyors

EXHIBIT "A"Dedication Description over Betts and Renoud Tract
(Tax Lots 2602 and 2603 – Map 11-3W-04AC)

A 5.00 foot strip of land located in portions of two tracts of land identified as Parcel I and Parcel II of that land owned by the Gary and Mary Betts and Rintha and Richard Renoud as described by deed recorded in MF Volume 1570, Page 489 of the Linn County Deed Records on April 22, 2004. The said strip of land also being located in Lots 3, 4 and 5 of "HARVEY'S SUBDIVISION", a subdivision of record in Linn County, Oregon, said strip of land being more particularly described as follows:

Beginning at the northeast corner of said Lot 4, which point being located on the westerly right-of-way line of Clover Ridge Road (a 40 foot wide right-of-way also know as County Road No. 320); thence South 00°38'45" East, along said right-of-way line, 220.76 feet to the southeast corner of said Lot 5, which point being on the north right-of-way line of Knox Butte Road (an 80 foot wide right-of-way also known as County Road No. 7); thence North 85°46'51" West, along said north right-of-way line, 5.02 feet to a 5/8 inch rod; thence North 00°38'45" West, parallel with said west right-of-way line, 220.43 feet to a 5/8 inch rod on the north line of said Lot 4; thence South 89°36'04" East 5.00 feet to the Point of Beginning.

July 6, 2004
EXHIBIT "A"
DEDICATION DESCRIPTION
BETTS AND RENOUD TRACT
(03-162) JJC:nm
File nm\COA\03-162\dedication desc.doc

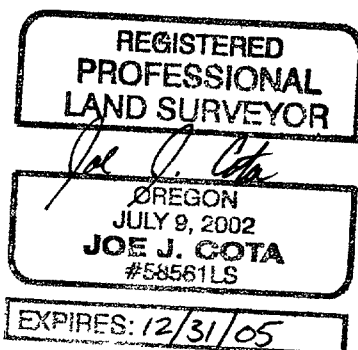

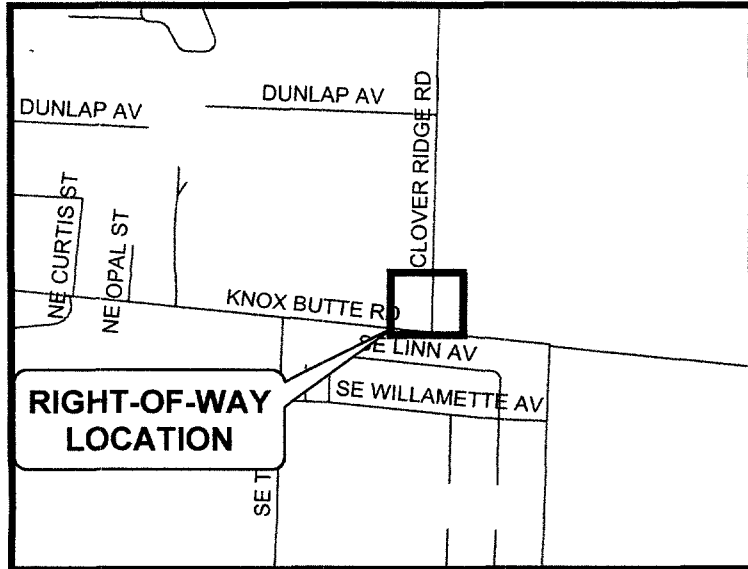

**Right-of-Way Acquisition
Clover Ridge Rd.**

**11S03W04AC02603
11S03W04AC02602**

**City of Albany
Linn Co., OR**

5 foot wide ROW

VICINITY MAP

1 inch equals 50 feet

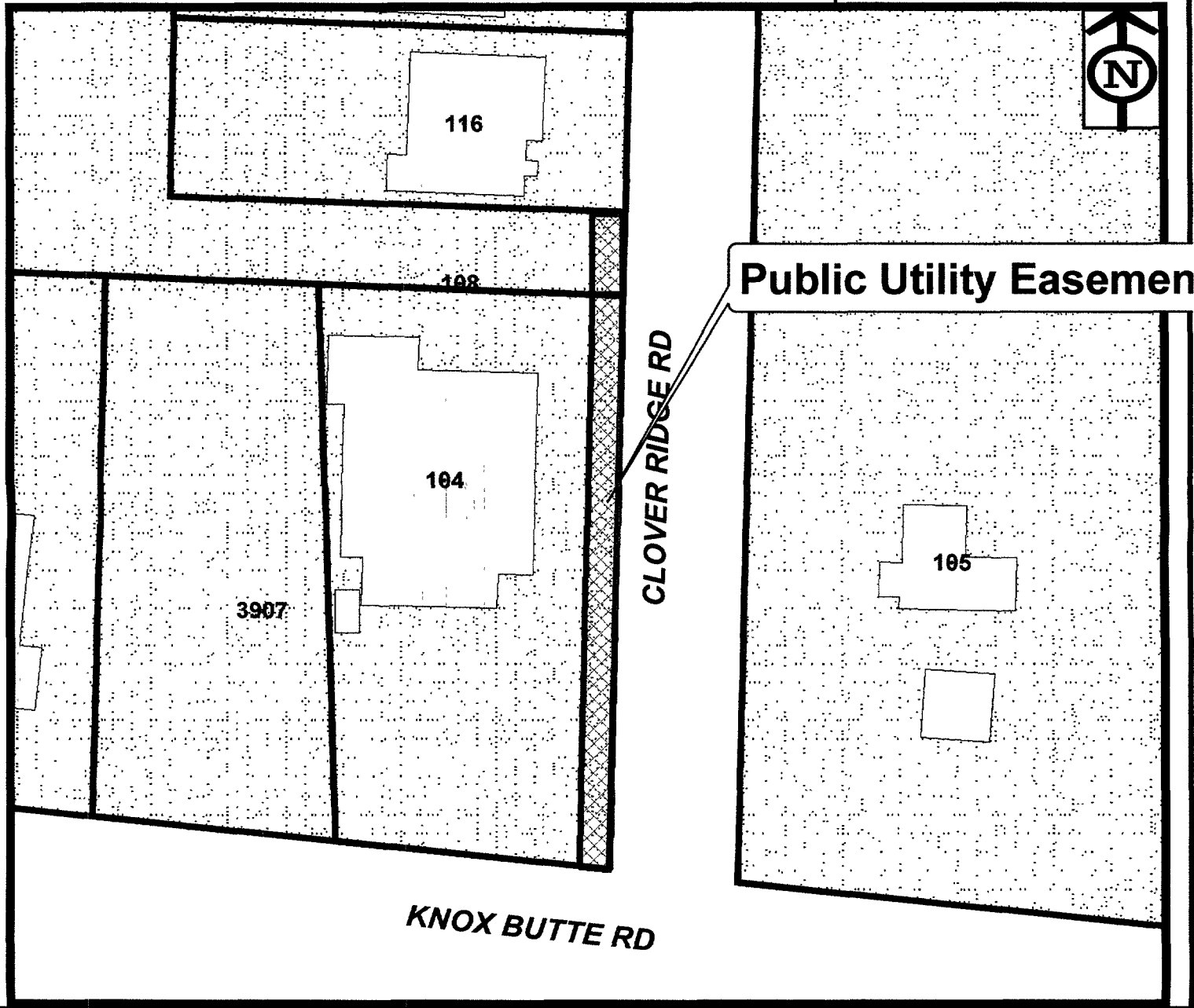
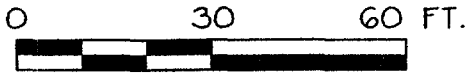

EXHIBIT "B"

RIGHT-OF-WAY ACQUISITION OF CLOVER RIDGE ROAD FOR

CITY OF ALBANY



SCALE: 1" = 30'

NE 1/4, SEC. 4, T. 11 S., R. 3 W., W.M.
CITY OF ALBANY, LINN COUNTY, OREGON
TAX LOT 2602 + 2603, MAP 11-03-4AC
JULY 6, 2004

VOL. 1620 PAGE 783 IN 89°31'04" W 5.00'

PARCEL I
OF
BETTS AND RENOUD TRACT
(MF 1570-489) AREA: 140 SF

AREA TO BE CONVEYED
TO THE CITY OF ALBANY

PARCEL II
OF
BETTS AND RENOUD TRACT
(MF 1570-489)



NEW WEST R-O-W LINE
OF CLOVER RIDGE RD

CLOVER RIDGE ROAD (COUNTY ROAD 320)

KNOX BUTTE ROAD
(COUNTY ROAD 7)

S 85°46'51" E 5.02' P.O.B.
SE CORNER OF
PARCEL II OF
"BETTS TRUST TRACT"

K & D ENGINEERING, Inc.

276 N.W. Hickory Street P.O. Box 725
Albany, Oregon 97321
(541) 928-2583

[N 85°46'51" W 783.62']

STATE OF OREGON
County of Linn

I hereby certify that the attached
was received and duly recorded
by me in Linn County records.

STEVE DRUCKENMILLER
Linn County Clerk

By UAD Deputy MF 1620
PAGE 781

M
R
S
A
O

2004 SEP -2 A 11: 21

46

Resolution No. 5024

Recorded Document Recorder File 4404