

RESOLUTION NO. 4597

A RESOLUTION ACCEPTING THE FOLLOWING EASEMENT:

Grantor

Barbara O'Rourke

Purpose

A permanent public utility easement described in attached EXHIBIT A and as shown in attached EXHIBIT B.

NOW, THEREFORE, BE IT RESOLVED by the Albany City Council that it does hereby accept this easement.

DATED THIS 9TH DAY OF JANUARY, 2002.

  
\_\_\_\_\_  
Mayor

ATTEST:

  
\_\_\_\_\_  
City Recorder

## EASEMENT FOR PUBLIC UTILITIES

THIS AGREEMENT, made and entered into this 9<sup>th</sup> day of Oct, 2001, by and **Barbara O'Rourke**, herein called Grantor, and the **CITY OF ALBANY**, a Municipal Corporation, herein called "City."

## WITNESSETH:

That the Grantor has this day granted unto the City of Albany, easement and right-of-way, including the right to enter upon the real property hereinafter described, and to maintain and repair public utilities for the purpose of conveying public utilities services over, across, through, and under the lands hereinafter described, together with the right to excavate and refill ditches and/or trenches for the location of the said public utilities and the further right to remove trees, bushes, under-growth, and other obstructions interfering with the location and maintenance of the said public utilities.

This agreement is subject to the following terms and conditions:

1. The right-of-way hereby granted consists of:
  - A 10.0-foot wide permanent public utility easement as shown on attached EXHIBIT B and described in attached EXHIBIT A.
2. In order that the work may be done in a timely and complete manner, we hereby agree to grant and allow a temporary right of entry for construction access to the City, its representatives and to the Contractor, for access to, upon and over our property for planning and construction of a sanitary sewer, service connection, and such appurtenances as are required to make the project complete. It is understood and agreed that this access agreement shall terminate on the date that such work has been satisfactorily completed and accepted by the City of Albany.
3. The permanent easement described herein grants to the City, and to its successors, assigns, authorized agents, or contractors, the perpetual right to enter upon said easement at any time that it may see fit, for construction, maintenance, evaluation and/or repair purposes.
4. The City agrees to replace the sanitary sewer service lateral **one time only**. The purpose of the replacement is to reduce infiltration to the public sanitary sewer system and protect the public health.
5. The Grantor does hereby covenant with the City that they are lawfully seized and possessed of the real property above described and that they have a good and lawful right to convey it or any part thereof and that they will forever warrant and defend the title thereto against the lawful claims of all persons whomsoever.
6. Upon performing any maintenance, the City shall return the site to original or better condition.
7. The Grantor and the City acknowledge that if a structure exists on the public utilities easement described herein either additional permanent structures or additions to the existing structure may not be constructed on the public utilities easement. If the existing structure is removed from the public utility easement, no permanent structure may be reconstructed in its place.

Return to: City of Albany Recorder  
P.O. Box 433, Albany, OR 97321

8. Should the City determine that maintenance, repair, or reconstruction of the utilities located under the structure requires the removal or alteration of said structure, the City may undertake such removal or alteration as may be needed. In such event, however, the City shall, upon completion of said maintenance, repair, or reconstruction, restore the structure at City expense to its original or better condition.

IN WITNESS WHEREOF, the Grantor has hereunto fixed his hand and seal the day and year above written.

GRANTOR:

Barbara O'Rourke  
Barbara O'Rourke

STATE OF OREGON )  
County of Linn ) ss.  
City of Albany )

The foregoing instrument was acknowledged before me this 9th day of October, 2001, by **Barbara O'Rourke** as her voluntary act and deed.

C. Marie Redner  
Notary Public for Oregon  
My Commission Expires: July 29, 2004

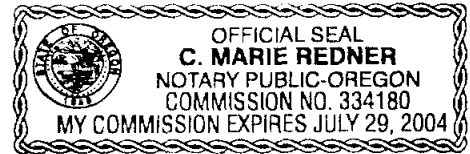

CITY OF ALBANY:

STATE OF OREGON )  
County of Linn ) ss.  
City of Albany )

I, **Steve Bryant** as City Manager of the City of Albany, Oregon, pursuant to Resolution Number 4597, do hereby accept on behalf of the City of Albany, the above instrument pursuant to the terms thereof this 10 day of January 2002.

Steve Bryant  
City Manager

ATTEST:  
[Signature]  
City Recorder

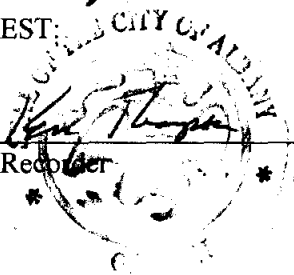



# EXHIBIT B

OROURKE  
PUBLIC UTILITY  
EASEMENT

LOT 18, BLOCK 8 OF MOTLEY'S ADDITION  
SECTION T 11 S, R 3 W, WILLAMETTE MERIDIAN, LINN COUNTY, OREGON

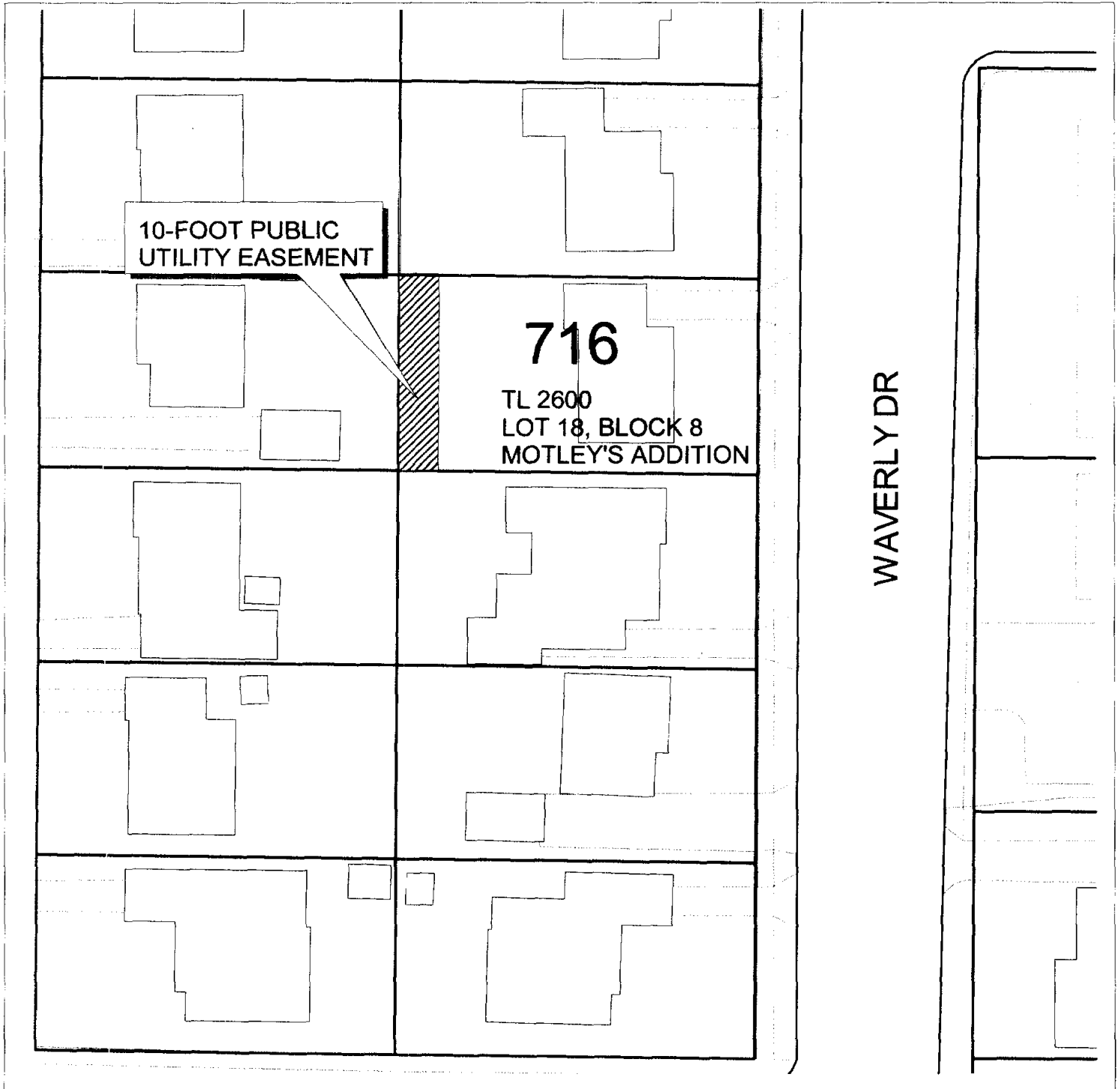

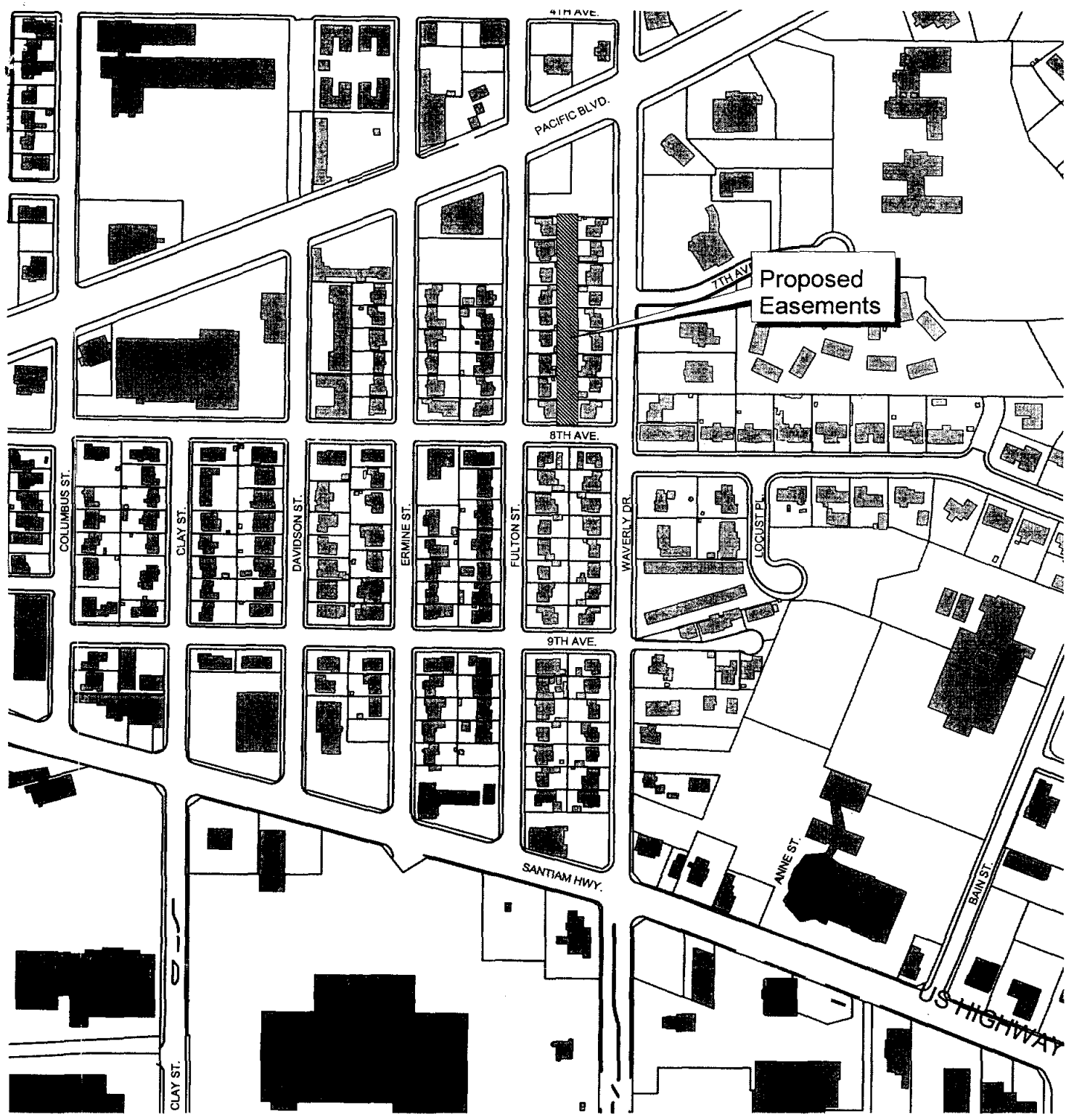

# VICINITY MAP



Waverly/Fulton/Pacific Perpetual Replacement  
SS-01-07

10' WIDE PUBLIC UTILITY EASEMENT  
Block 8 - Motley's Addition



Kelly Albers

Engineering

angies J:\AV\_PROJ\SITE\_MAP.APR

Sept. 4, 2001

The City of Albany's infrastructure records, drawings, and other documents have been gathered over many decades, using differing standards for quality control, documentation, and verification. All the information provided represents current information in a readily available format. While the information provided is generally believed to be accurate, occasionally this information proves to be incorrect, and thus its accuracy is not warranted. Prior to making any property purchases or other investments based in full or in part upon the information provided, it is specifically advised that you independently verify the information contained within our records.



EXHIBIT A

PERMANENT UTILITY EASEMENT

A permanent public utility easement across that property conveyed to Barbara O'Rourke, described in Volume 1112, Page 714, Linn County Microfilm Deed Records, said easement being more particularly described as follows and as shown on the attached map labeled "EXHIBIT B".

The Western 10 feet of Lot 18, Block 8, Motley's Addition to the City of Albany, Section 8, T. 11S., R3W., Willamette Meridian, Linn County Oregon. A subdivision recorded in Linn County, Records in Book of Plats, Volume 8, pg. 28, on the 15<sup>th</sup> day of February, 1946

Containing 0.0126 acres of land, more or less.

STATE OF OREGON  
County of Linn

I hereby certify that the attached  
was received and duly recorded  
by me in Linn County records.

STEVE DRUCKENMILLER  
Linn County Clerk

By SR, Deputy

MF 1256  
91

2002 JAN 18 P 2:37

46

Resolution No. 4597

Recorded Document Recorder File 4051