

RESOLUTION NO. 4529

A RESOLUTION ACCEPTING THE FOLLOWING DEDICATION DEED:

Grantor

Purpose

June N. Sloan
Michael J. Sloan

A permanent Dedication Deed described in attached EXHIBIT A and as shown in attached EXHIBIT B.

NOW, THEREFORE, BE IT RESOLVED by the Albany City Council that it does hereby accept this easement.

DATED THIS 10TH DAY OF OCTOBER, 2001.



Mayor

ATTEST:



City Clerk

DEDICATION DEED
N-012

June + Michael

KNOW ALL MEN BY THESE PRESENTS, that the Sloan's, hereinafter referred to as the Grantor, does dedicate to the City of Albany for street and utility right-of-way purposes situated in Linn County, State of Oregon, described as follows:

A tract of land as described in the attached description and as shown on Attached EXHIBIT A.

and covenants that the Grantor is the owner of the above described real property free of all encumbrances save and except reservations in patents and easements or record, and will warrant and defend the same against all persons who may lawfully claim the same.

The deed granted herein is in consideration of \$1.00, receipt of which is acknowledged by the Grantor, and in further consideration of the public improvements to be placed upon said property and the benefits grantors may obtain there from. Nothing herein shall reduce or limit grantors obligation to pay any costs or assessments, which may result from the improvements.

IN WITNESS WEREOF, the Grantors have hereunto affixed their signatures this 29th day of May, 2001.

GRANTOR:

GRANTOR:

June N Sloan
JUNE N. SLOAN

Michael J Sloan
MICHAEL J. SLOAN

STATE OF OREGON)
County of Linn)
City of Albany)

STATE OF OREGON)
STATE OF OREGON)
City of Albany)

The foregoing instrument was acknowledged Before me this 29th-day of May, 2001 by his voluntary act and deed.

The foregoing instrument was acknowledged Before me this 29th-day of May, 2001 by his voluntary act and deed.

Matthew A. Ruettgers
Notary Public for Oregon
My Commission Expires: 2-28-05

Matthew A. Ruettgers
Notary Public for Oregon
My Commission Expires: 2-28-05

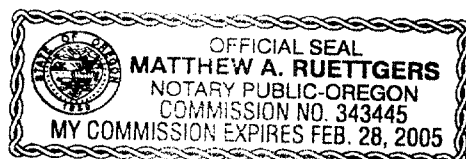
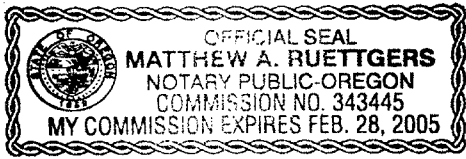

Return to: City of Albany - Recorder
P.O. Box 490, Albany, OR 97321

CITY OF ALBANY

STATE OF OREGON)
County of Linn)
City of Albany)

I, Steve Bryant as City Manager of the
City of Albany, Oregon, pursuant to Resolution
Number 4529, do hereby accept on
Behalf of the City of Albany, the above
Instrument pursuant to the terms thereof this
11 Day of October,
2001.

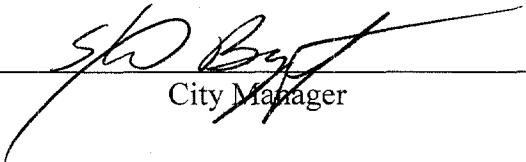

City Manager

ATTEST:



City Recorder Clerk

DEDICATION DEED TO THE CITY OF ALBANY

N-012

A portion of that certain tract of land described in Vol 536 Page 162 of Linn County Deed of Records, described as follows:

Beginning at the southwest corner of said tract, thence a distance of 21 feet along its West line to a point; thence to a point lying on the South line of said tract and being 7 feet from its southwest corner; thence along the South line to the point of beginning, All lying in the SE ¼ of Section 17, Township 11 South, Range 03 West, Willamette Meridian, Linn County, Oregon and containing 73 square feet, more or less.

For reference purposes, this tract of land can be seen on tax assessors map 113W17DB tax lot 1200, and on the attached exhibit 'A'.



Leonard L. Smith



RENEWAL 6/30/2002

EXHIBIT 'A'
N-012

STREET ADDRESS 3389
TAX MAP 113W17DB
TAX LOT 1200



SCALE: NTS

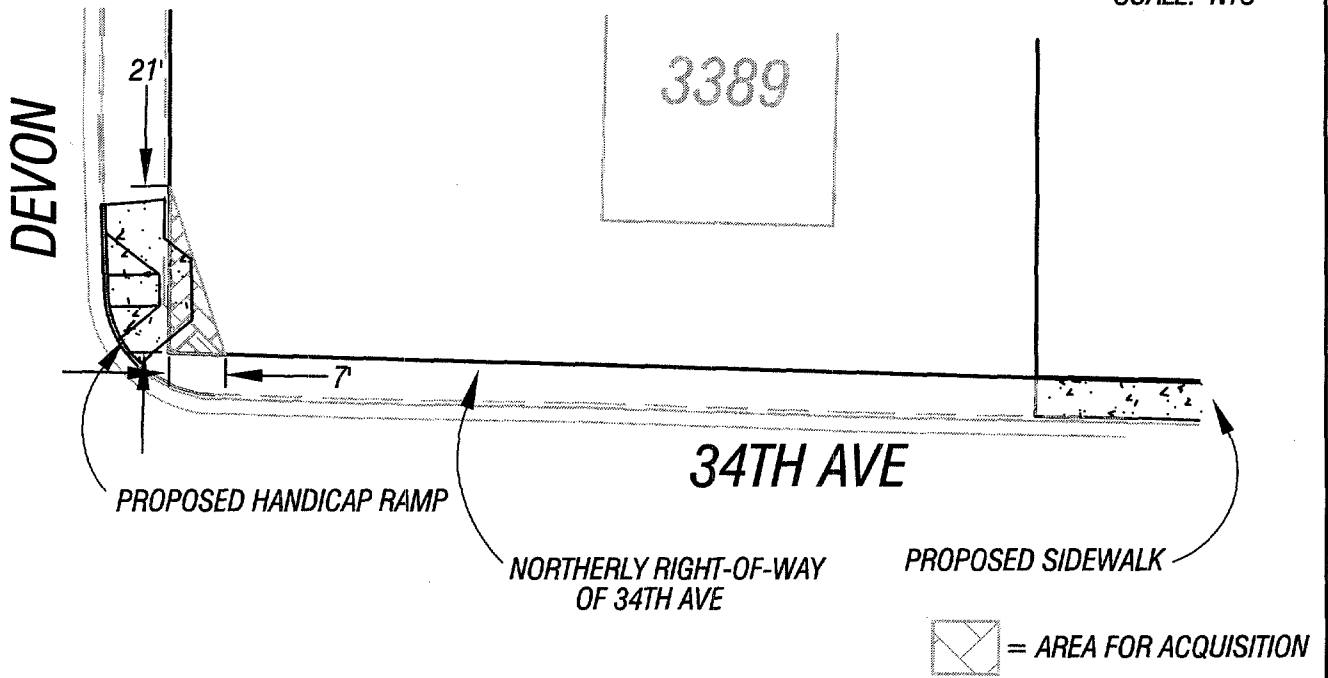

<p>REGISTERED PROFESSIONAL LAND SURVEYOR</p> <p><i>Leonard L. Smith</i></p> <p>OREGON SEPTEMBER 23, 1977 LEONARD L. SMITH 1329</p> <p>RENEWAL 6/30/2002</p>	<p>PacWest Engineering</p> <p>1530 NINTH AVE. SE TEL 1-888-926-7634 ALBANY, OR. 97321 FAX 541-926-7539</p>		Project: 99-051
	Client: CITY OF ALBANY		Drawing No.: ROWTAKES/BASE
	Drawn: J. BLAINE	Field: D. BECKER	Date: 02-22-01
	Calc'd: J. BLAINE	Checked: L. SMITH	Scale: NTS
		Page Of 2 2	

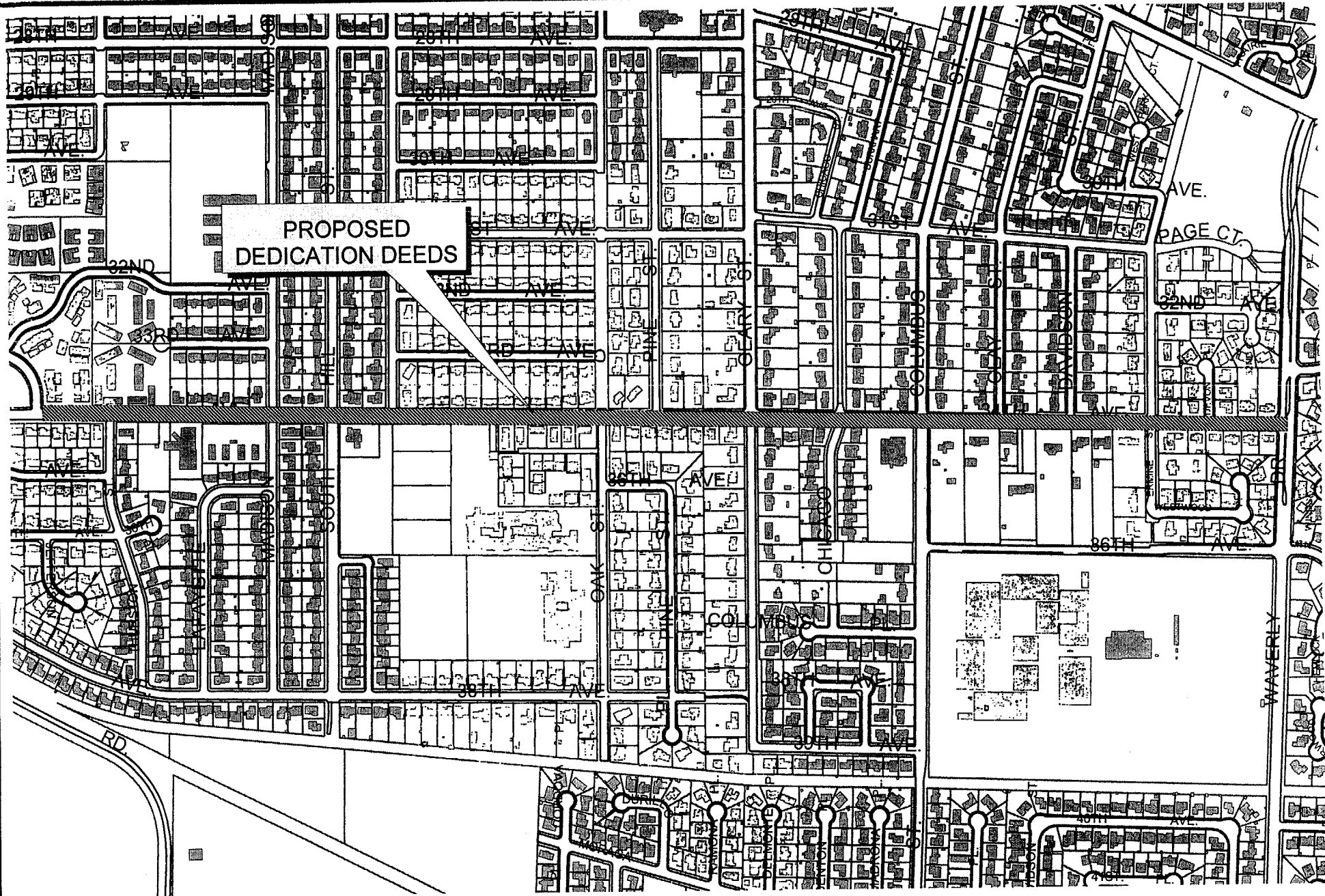

NO. 1226 PAGE 607

VICINITY MAP

ST-01-01 34th Ave, Rehabilitation, Phase II



Dedication Deeds

Engineering - Angie

angles.g:\engineer\gis\vicinity map.apr

Mark Shepard

Sep 28, 2001

600 0 600 Feet

The City of Albany's Infrastructure records, drawings, and other documents have been gathered over many decades, using differing standards for quality control, documentation, and verification. All the information provided represents current information in a readily available format. While the information provided is generally believed to be accurate, occasionally this information proves to be incorrect, and thus its accuracy is not warranted. Prior to making any property purchase or other investments based in full or in part upon the information provided, it is specifically advised that you independently field verify the information contained within our records.



46

STATE OF OREGON
County of Linn

I hereby certify that the attached
was received and duly recorded
by me in Linn County records.

STEVE DRUCKENMILLER
Linn County Clerk

By SL, Deputy

M
R 25
S 10
A 11
O

MF 1226

2001 OCT 22 P 1:57

PAGE 603

Resolution No. 4529

Recorded Document Recorder File 3912