

RESOLUTION NO. 4528

A RESOLUTION ACCEPTING THE FOLLOWING DEDICATION DEED:

Grantor

Dan D. Cano

Purpose

A permanent Dedication Deed described in attached EXHIBIT A and as shown in attached EXHIBIT B.

NOW, THEREFORE, BE IT RESOLVED by the Albany City Council that it does hereby accept this easement.

DATED THIS 10TH DAY OF OCTOBER, 2001.

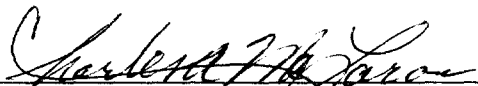

Mayor

ATTEST:



City Clerk

DEDICATION DEED
N-011

KNOW ALL MEN BY THESE PRESENTS, that Dan D. Cano, hereinafter referred to as the Grantor, does dedicate to the City of Albany for street and utility right-of-way purposes situated in Linn County, State of Oregon, described as follows:

A tract of land as described in the attached description and as shown on Attached EXHIBIT A.

and covenants that the Grantor is the owner of the above described real property free of all encumbrances save and except reservations in patents and easements or record, and will warrant and defend the same against all persons who may lawfully claim the same.

The deed granted herein is in consideration of \$1.00, receipt of which is acknowledged by the Grantor, and in further consideration of the public improvements to be placed upon said property and the benefits grantors may obtain there from. Nothing herein shall reduce or limit grantors obligation to pay any costs or assessments, which may result from the improvements.

23rd IN WITNESS WHEREOF, the Grantors have hereunto affixed their signatures this July, 2001.

GRANTOR:

GRANTOR:

Dan D. Cano
DAN D. CANO

STATE OF OREGON)
County of Linn)
City of Albany)

STATE OF OREGON)
STATE OF OREGON)
City of Albany)

The foregoing instrument was acknowledged Before me this 23rd-day of July, 2001 by his voluntary act and deed.

The foregoing instrument was acknowledged Before me this ____-day of _____, ____ by his voluntary act and deed.

Matthew A. Ruettgers
Notary Public for Oregon
My Commission Expires: 2-28-05

Notary Public for Oregon
My Commission Expires: _____

Return to: City of Albany - Recorder
P.O. Box 490, Albany, OR 97321

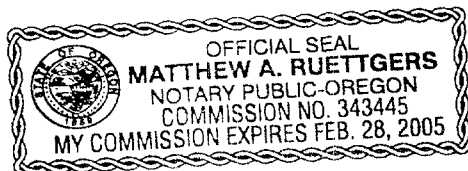

CITY OF ALBANY

STATE OF OREGON)
County of Linn)
City of Albany)

I, Steve Bryant as City Manager of the
City of Albany, Oregon, pursuant to Resolution
Number 4528, do hereby accept on
Behalf of the City of Albany, the above
Instrument pursuant to the terms thereof this
11 Day of October,
2001.

Steve Bryant
City Manager

ATTEST:

Margaret Langwell
City Recorder



DEDICATION DEED TO THE CITY OF ALBANY

N-011

A portion of that certain tract of land described in Vol 1045 Page 541 of Linn County Deed of Records, described as follows:

Beginning at the southeast corner of said tract, thence a distance of 18 feet along its east line to a point; thence to a point lying on the south line of said tract and being 13 feet from its southeast corner; thence along the south boundary line to the point of beginning, All lying in the SE ¼ of Section 17, Township 11 South, Range 03 West, Willamette Meridian, Linn County, Oregon and containing 117 square feet, more or less.

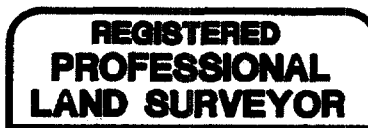
For reference purposes, this tract of land can be seen on tax assessors map 113W17DB tax lot 900, and on the attached exhibit 'A'.



Leonard L. Smith



RENEWAL 6/30/2002

EXHIBIT 'A'
N-011

STREET ADDRESS 3388
TAX MAP 113W17DB
TAX LOT 900



SCALE: NTS

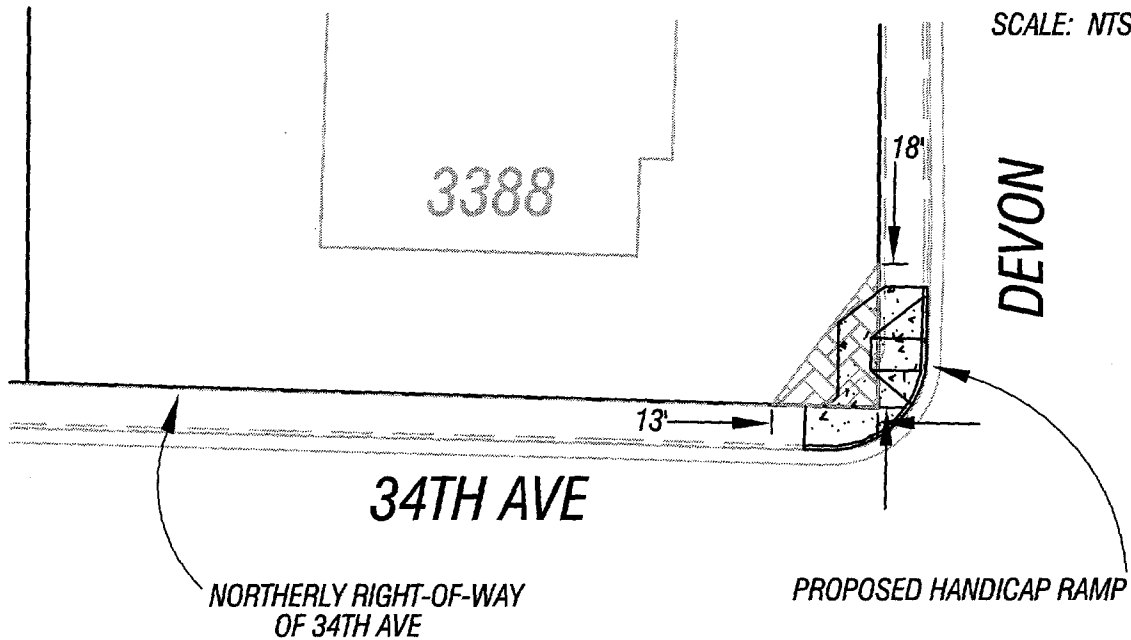

= AREA FOR ACQUISITION

<p>REGISTERED PROFESSIONAL LAND SURVEYOR</p> <p><i>Leonard L. Smith</i></p> <p>OREGON SEPTEMBER 23, 1977 LEONARD L. SMITH 1329</p> <p>RENEWAL 6/30/2002</p>	<p>PacWest Engineering</p> <p>1530 NINTH AVE. SE TEL 1-888-926-7634 ALBANY, OR. 97321 FAX 541-926-7539</p>		Project: 99-051
	Client: CITY OF ALBANY		Drawing No.: ROWTAKES/BASE
Drawn: J. BLAINE	Field: D. BECKER	Date: 02-22-01	Scale: NTS
Calc'd: J. BLAINE	Checked: L. SMITH	Page Of 2 2	

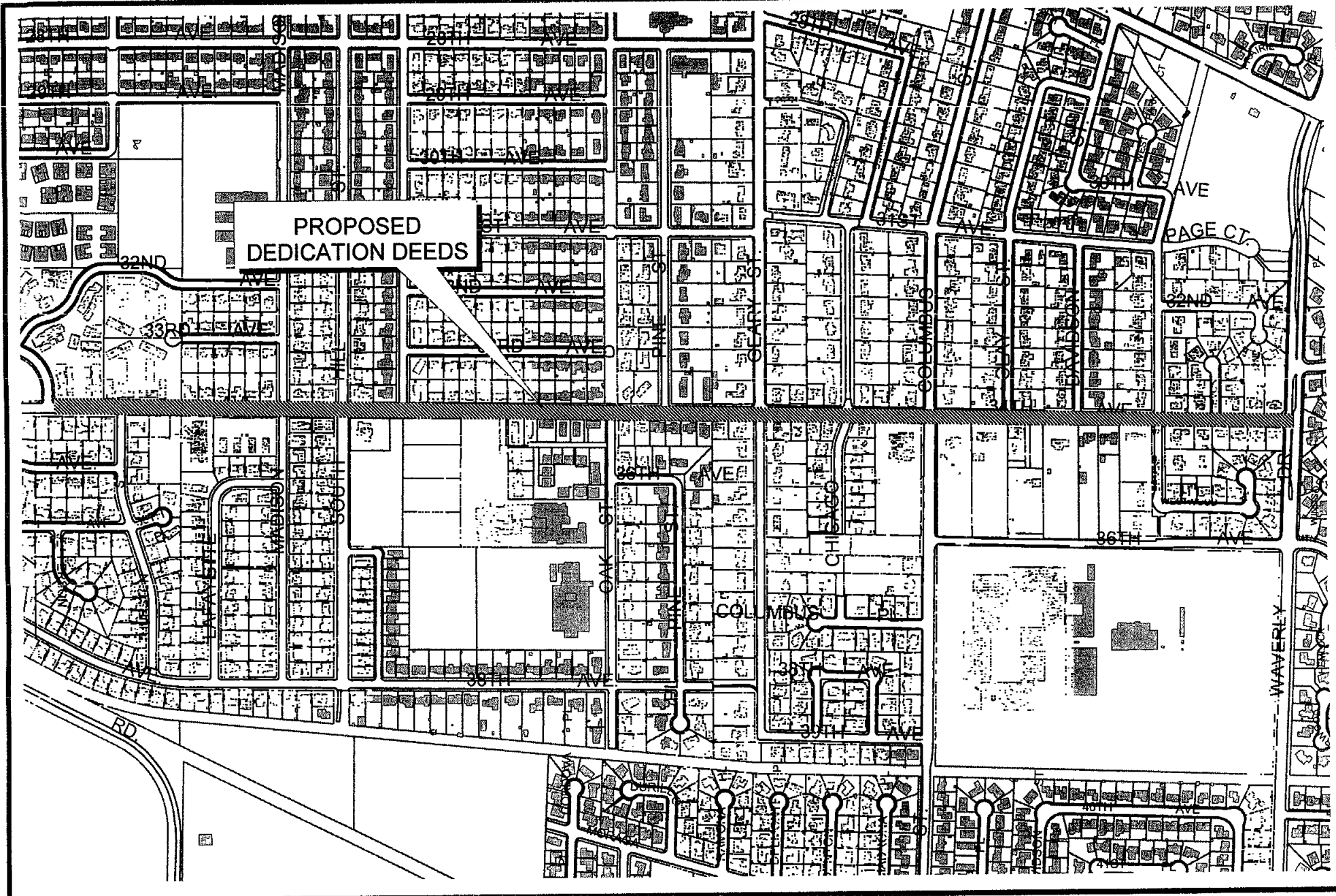

VOL 1226 Part 613

VICINITY MAP

ST-01-01 34th Ave, Rehabilitation, Phase II



Dedication Deeds

Engineering - Angie

Mark Shepard

Sep 28, 2001

angie.g@engineer@vicinity map apr

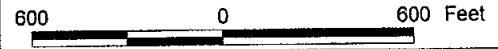

The City of Albany's Infrastructure records, drawings and other documents have been gathered over many decades, using differing standards for quality control, documentation and verification. All the information provided represents current information in a readily available format. While the information provided is generally believed to be accurate, occasionally this information proves to be incorrect and thus its accuracy is not warranted. Prior to making any property purchase or other investments based in full or in part upon the information provided, it is specifically advised that you independently field verify the information contained within our records.



46

STATE OF OREGON
County of Linn

I hereby certify that the attached
was received and duly recorded
by me in Linn County records.

STEVE DRUCKENMILLER
Linn County Clerk

By SR, Deputy

M
25
S
70
A
44
O

MF 1226

PAGE 609

2001 OCT 22 P 1:57

Resolution No. 4528

Recorded Document Recorder File 3913