

RESOLUTION NO. 4511

A RESOLUTION ACCEPTING THE FOLLOWING DEDICATION DEED:

Grantor

Ronald L. Shinn  
Teresa M. Shinn

Purpose

A permanent Dedication Deed described in attached EXHIBIT A and as shown in attached EXHIBIT B.

NOW, THEREFORE, BE IT RESOLVED by the Albany City Council that it does hereby accept this easement.

DATED THIS 10TH DAY OF OCTOBER, 2001.

  
\_\_\_\_\_  
Mayor

ATTEST:

  
\_\_\_\_\_  
City Clerk

DEDICATION DEED  
S-001

Ronald + Teresa

KNOW ALL MEN BY THESE PRESENTS, that ~~the Shinn's~~, hereinafter referred to as the Grantor, does dedicate to the City of Albany for street and utility right-of-way purposes situated in Linn County, State of Oregon, described as follows:

A tract of land as described in the attached description and as shown on Attached EXHIBIT A.

and covenants that the Grantor is the owner of the above described real property free of all encumbrances save and except reservations in patents and easements or record, and will warrant and defend the same against all persons who may lawfully claim the same.

The deed granted herein is in consideration of \$1.00, receipt of which is acknowledged by the Grantor, and in further consideration of the public improvements to be placed upon said property and the benefits grantors may obtain there from. Nothing herein shall reduce or limit grantors obligation to pay any costs or assessments, which may result from the improvements.

IN WITNESS WHEREOF, the Grantors have hereunto affixed their signatures this 21<sup>ST</sup> day of May, 2001.

Return to: City of Albany - Recorder  
P.O. Box 490, Albany, OR 97321

GRANTOR:

Ronald L. Shinn  
RONALD L. SHINN

STATE OF OREGON     )  
County of Linn        )  
City of Albany        )

The foregoing instrument was acknowledged Before me this 21<sup>ST</sup>-day of May, 2001 by his voluntary act and deed.

Matthew A. Ruettgers  
Notary Public for Oregon  
My Commission Expires: 2-28-05

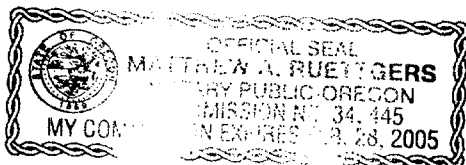

GRANTOR:

Teresa Shinn  
TERESA M. SHINN

STATE OF OREGON     )  
STATE OF OREGON     )  
City of Albany        )

The foregoing instrument was acknowledged Before me this 21<sup>ST</sup>-day of May, 2001 by his voluntary act and deed.

Matthew A. Ruettgers  
Notary Public for Oregon  
My Commission Expires: 2-28-05

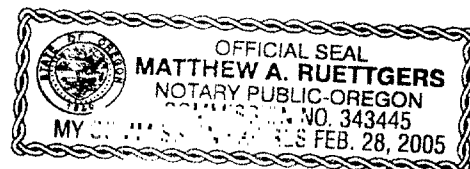

S-001

CITY OF ALBANY

STATE OF OREGON )  
County of Linn )  
City of Albany )

I, Steve Bryant as City Manager of the  
City of Albany, Oregon, pursuant to Resolution  
Number 4511, do hereby accept on  
Behalf of the City of Albany, the above  
Instrument pursuant to the terms thereof this  
11 Day of October  
2001.

Steve Bryant  
City Manager

ATTEST

Margaret Langmuir  
City Recorder Clerk

**DEDICATION DEED TO THE CITY OF ALBANY**

S-001

A portion of that certain tract of land described in Vol 1119 Page 710 of Linn County Deed of Records, described as follows:

Beginning at the northeast corner of said tract, thence a distance of 19 feet along its east line to a point; thence to a point lying on the north line of said tract and being 24 feet from the point of beginning; thence along said north line to the point of beginning.

**Also:**

Beginning at a point on the north line of said tract that lies 56 feet from its northeast corner, thence leaving said line at right angles a distance of 4 feet; thence parallel to the north line of said tract a distance of 4 feet to a point; thence to a point on the north line of said tract that lies 60 feet from the point of beginning; thence along said north line to the point of beginning.

All lying in the SW ¼ of Section 17, Township 11 South, Range 03 West, Willamette Meridian, Linn County, Oregon and containing 244 square feet, more or less.

For reference purposes, this tract of land can be seen on tax assessors map 113W17CC tax lot 300, and on the attached exhibit 'A'.

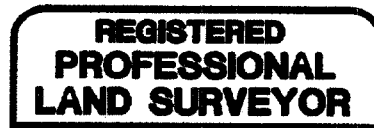

*Leonard L. Smith*



RENEWAL 6/30/2002

**EXHIBIT 'A'**

S-001

**STREET ADDRESS 3317  
TAX MAP 113W17CC  
TAX LOT 300**

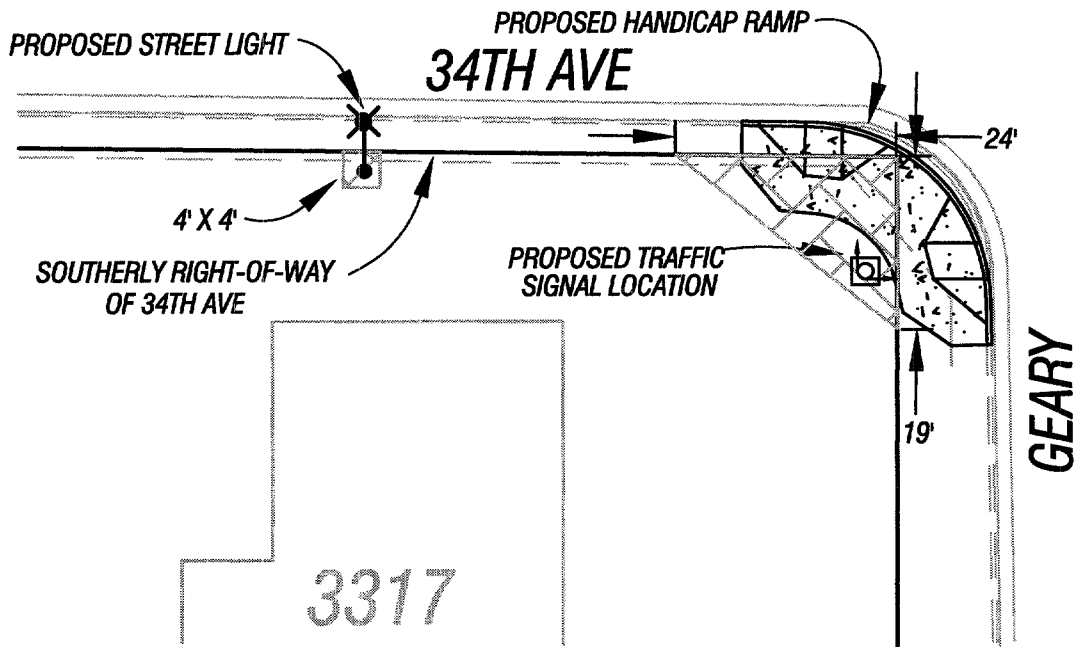

SCALE: NTS

= AREA FOR ACQUISITION

<p><b>REGISTERED PROFESSIONAL LAND SURVEYOR</b></p> <p><i>Leonard L. Smith</i></p> <p><b>OREGON SEPTEMBER 23, 1977 LEONARD L. SMITH 1329</b></p> <p>RENEWAL 6/30/2002</p>	<p><b>PacWest</b> Engineering</p> <p>1530 NINTH AVE. SE TEL 1-888-926-7634 ALBANY, OR. 97321 FAX 541-926-7539</p>		<p>Project: 99-051</p>
	<p>Client: CITY OF ALBANY</p>		<p>Drawing No.: ROWTAKES/BASE</p>
	<p>Drawn: J. BLAINE</p>	<p>Field: D. BECKER</p>	<p>Date: 02-22-01</p>
	<p>Calc'd: J. BLAINE</p>	<p>Checked: L. SMITH</p>	<p>Scale: NTS</p>
			<p>Page Of 2 2</p>

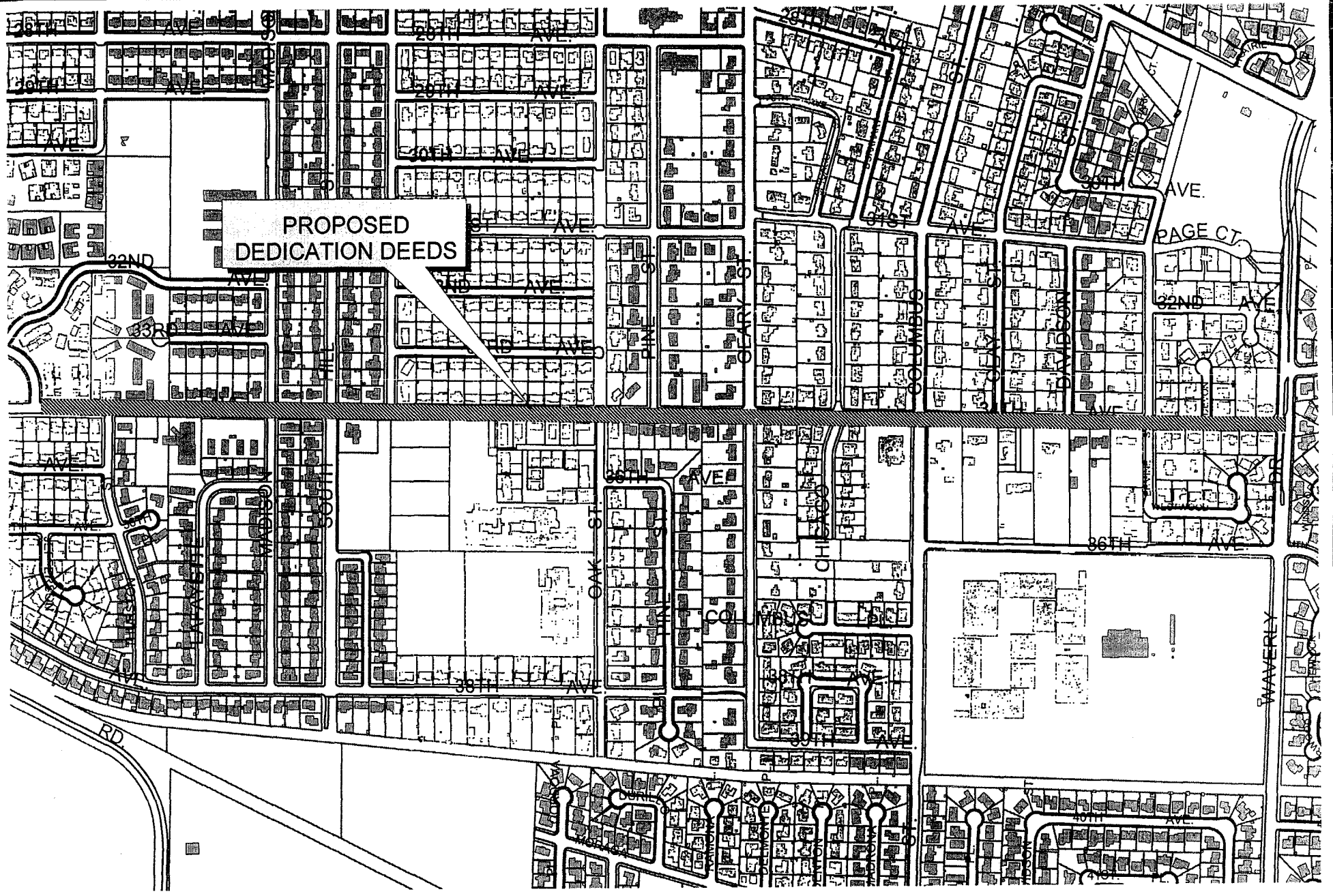

**VICINITY MAP**

**ST-01-01 34th Ave, Rehabilitation, Phase II**



Dedication Deeds

Engineering - Angie

angles.g:\engineer\gis\vicinity map.apr

Mark Shepard

Sep 28, 2001

600 0 600 Feet



The City of Albany's Infrastructure records, drawings, and other documents have been gathered over many decades, using differing standards for quality control, documentation, and verification. All the information provided represents current information in a readily available format. While the information provided is generally believed to be accurate, occasionally this information proves to be incorrect, and thus its accuracy is not warranted. Prior to making any property purchases or other investments based in full or in part upon the information provided, it is specifically advised that you independently field verify the information contained within our records.



STATE OF OREGON  
County of Linn

I hereby certify that the attached  
was received and duly recorded  
by me in Linn County records.

STEVE DRUCKENMILLER  
Linn County Clerk

By SR, Deputy

M  
R  
S  
A  
O

1226

MF

PAGE 574

2001 OCT 22 P 1:57

46

Resolution No. 4511

Recorded Document Recorder File 3907