

RESOLUTION NO. 2416

A RESOLUTION FOR THE ADOPTION OF ENGINEERING REPORTS, AUTHORIZATION TO SECURE EASEMENTS, TO OBTAIN BIDS, TO INCREASE APPROPRIATIONS, AND TO ISSUE WARRANTS FOR THE CONSTRUCTION OF SS-83-2, 32ND AVENUE, AND SS-83-4, ALBANY RESIDENTIAL CARE CENTER.

BE IT RESOLVED that the engineering reports of the Public Works Director filed with the City Recorder on the 18th day of August, 1983, concerning SS-83-2, 32nd Avenue, and SS-83-4, Albany Residential Care Center, be and the same are hereby adopted.

BE IT FURTHER RESOLVED that the Council authorize the Mayor and City Recorder to sign agreements on behalf of the City of Albany for the purpose of obtaining easements to construct the said improvements, direct the City Manager to obtain bids for the construction of said projects as required by law, and authorize the Mayor and City Recorder to make, issue, and negotiate General Obligation Improvement Warrants for the performance of said improvements, bearing interest not to exceed 12% per annum, and constituting general obligations of the City of Albany. The terms of conditions of such warrants shall be as provided by ORS 287.502 to 287.510.

BE IT FURTHER RESOLVED that funds budgeted within the Improvement Fund be appropriated as follows:

<u>RESOURCE</u>	<u>FROM</u>	<u>TO</u>
<u>Improvement Fund</u>		
26-985-86001 (SS-83-2)	\$19,250.00	
26-985-86001 (SS-83-4)	4,917.00	
<u>REQUIREMENT</u>		
<u>Improvement Fund</u>		
26-985-89064 (SS-83-2)		\$19,250.00
26-985-89065 (SS-83-4)		4,917.00

DATED this 24th day of August, 1983.

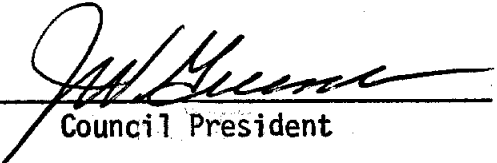
  
\_\_\_\_\_  
Council President

ATTEST:

  
\_\_\_\_\_  
Deputy City Recorder

INTERDEPARTMENTAL MEMORANDUM  
Public Works Department  
Engineering/Wastewater Division

TO: Albany City Council  
VIA: Bill Barrons, City Manager  
FROM: John Joyce, Public Works Director  
DATE: August 15, 1983 for the August 24, 1983 Council Meeting  
SUBJECT: Engineer's Report for SS-83-2 32nd Ave. Sanitary Sewer

Description of Project

This project will provide sanitary sewer service for Albany Titanium, Inc., at the end of 32nd Avenue east of Pacific Blvd.

The project will include 460 lineal feet of 8" sanitary sewer pipe.

There are no easements necessary for this project.

Albany Titanium has signed a Waiver of Remonstrance for the project, therefore, a public hearing is not necessary.

Summary of Estimated Cost

A.	Total Estimated Construction Cost	\$17,500.00
B.	10% Contingencies	1,750.00
C.	Subtotal	<u>\$19,250.00</u>
D.	13% ELA	2,502.50
E.	Warrant Interest	703.50
F.	TV Inspection (\$0.80 X 460)	368.00
G.	Total Estimated Assessment (Lump Sum)	<u>\$22,824.00</u>

Method of Assessment

It is proposed that the assessment be on a lump sum basis as there is only one benefitting property owner.

Respectfully submitted,

*Mark A. Yeager*

Mark A. Yeager, P.E.  
Engineering/Wastewater Division Manager

Approved by,

*John Joyce*

John Joyce, P.E.

Public Works Director

ESTIMATED  
PROPERTY AND ASSESSMENT DATA

SS-83-2 32nd Avenue Sanitary Sewer

Office of the Public Works Director

NO.	OWNER/ADDRESS	TAX LOT & DESCRIPTION	TOTAL ESTIMATED ASSESSMENT
1.	Albany Titanium, Inc. P.O. Box 887 Albany, OR 97321	11-4W-13DA Tax Lot #500  Beginning at a point that is 44.00 feet North 00°54' West and 388.97 feet North 89°06' East and North 00°59'21" West, 313.06 feet from the Northwest corner of the Truett Davis Donation Land Claim No. 38 in Township 11 South, Range 4 West and Donation Land Claim No. 54 in Township 11 South, Range 3 West, Willamette Meridian, Linn County, Oregon; and running thence North 00°59'21" West 51.48 feet to a 1/2 inch iron rod; thence North 00°49' West 150.10 feet to a point; thence North 89°05'14" East 141.09 feet to a 5/8 inch iron rod; thence North 00°49' West 50.00 feet to a 5/8 inch iron rod; thence South 89°05'14" West 59.16 feet to a 5/8 inch iron rod; thence North 00°54'23" West 98.40 feet to a 5/8 inch iron rod; thence North 89°05'37" East 393.09 feet to a 5/8 inch iron rod; thence South 00°49' East 350.00 feet to a 5/8 inch iron rod; thence South 89°06' West 474.71 feet to the point of beginning. This parcel contains 3.467 acres, more or less.  Reserving an easement for roadway purposes the easterly 40 feet of even width of the above described parcel.	\$22,824.00

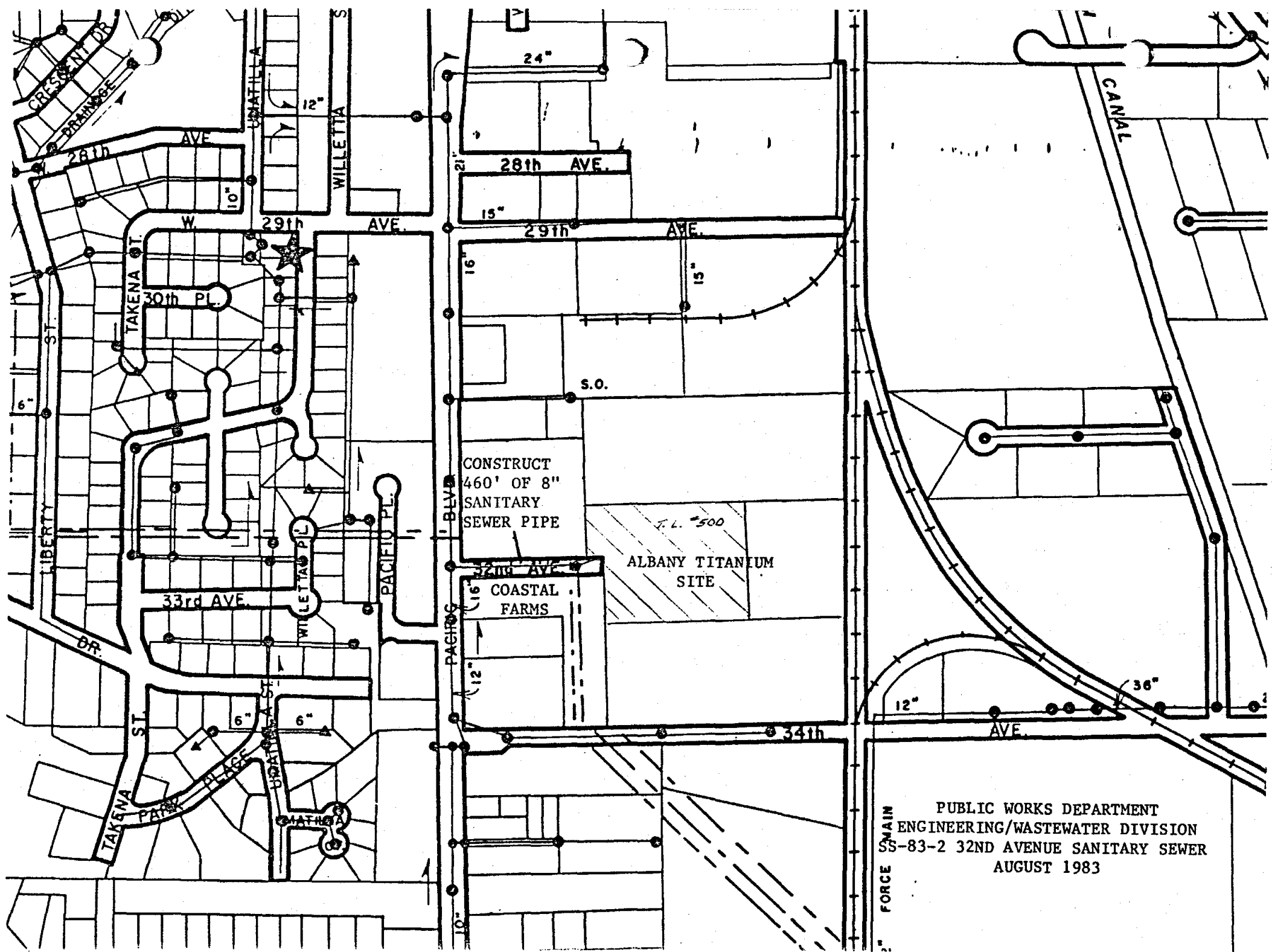

CONSTRUCT  
460' OF 8"  
SANITARY  
SEWER PIPE

ALBANY TITANIUM  
SITE

COASTAL  
FARMS

PUBLIC WORKS DEPARTMENT  
ENGINEERING/WASTEWATER DIVISION  
SS-83-2 32ND AVENUE SANITARY SEWER  
AUGUST 1983

FORCE MAIN

INTERDEPARTMENTAL MEMORANDUM  
Public Works Department  
Engineering/Wastewater Division

TO: Albany City Council  
VIA: Bill Barrons, City Manager  
FROM: John Joyce, Public Works Director  
DATE: August 15, 1983 for the August 24, 1983 Council Meeting  
SUBJECT: Engineer's Report for SS-83-4 Albany Residential Center  
(16th Avenue and Davidson Street) Sanitary Sewer

Description of Project

This project will provide sanitary sewer service for Albany Residential Center, at the northwest corner of 16th Avenue and Davidson Street.

The project will include 105 lineal feet of 8" sanitary sewer pipe.

There are no easements necessary for this project.

Albany Residential Center has signed a Waiver of Remonstrance for the project, therefore, a public hearing is not necessary.

Summary of Estimated Cost

A.	Total Estimated Construction Cost	\$ 4,470.00
B.	10% Contingencies	447.00
C.	Subtotal	\$ 4,917.00
D.	13% ELA	639.21
E.	Warrant Interest	200.79
F.	TV Inspection (\$0.80 X 105)	84.00
G.	Total Estimated Assessment (Lump Sum)	\$ 5,841.00

Method of Assessment

It is proposed that the assessment be on a lump sum basis as there is only one benefitting property owner.

Respectfully submitted,

*Mark A. Yeager*  
Mark A. Yeager, P.E.  
Engineering/Wastewater Division Manager

Approved by,  
*John Joyce*  
John Joyce, P.E.  
Public Works Director

ESTIMATED  
PROPERTY AND ASSESSMENT DATA

SS-83-4 Albany Residential Center Sanitary Sewer

Office of the Public Works Director

NO.	OWNER/ADDRESS	TAX LOT & DESCRIPTION	TOTAL ESTIMATED ASSESSMENT
1.	Albany Residential Center 3508 Red Cedar Way Lake Oswego, OR 97034	11-3W-8D Parcel 'A' of C.S. #15922  Beginning at a point which is on the North right-of-way line of 16th Avenue in the City of Albany, Linn County, Oregon, said point being 1899.48 feet North 88°48'05" West of the Southeast corner of the Abram Hackleman Donation Land Claim No. 62 in Section 8, T11S, R3W, W.M., Linn County, Oregon. Thence along said Northerly line of 16th Avenue N 89°48'05" W 1.97 feet; thence along said Northerly line, on a 250 foot radius curve to the right, the long chord of which bears N 65°49'13" W 203.22 feet; thence along said Northerly line, on a 250 foot radius curve to the left, the long chord of which bears N 56°06'27" W 123.23 feet; thence N 1°25'10" W 189.79 feet; thence N 88°34'50" E 324.73 feet to the Westerly right-of-way line of Davidson Street; thence along said Westerly line, on a 375 foot radius curve to the right the long chord of which bears S 9°40'05" W 51.20 feet; thence along said Westerly line, on a 430 foot radius curve to the left, the long chord of which bears S 7°31'44" W 90.70 feet; thence along said Westerly line S 1°28'29" W 198.05 feet and S 22°29'06" W 12.29 feet to the point of beginning. Containing 2.00 acres more or less.	\$ 5,841.00

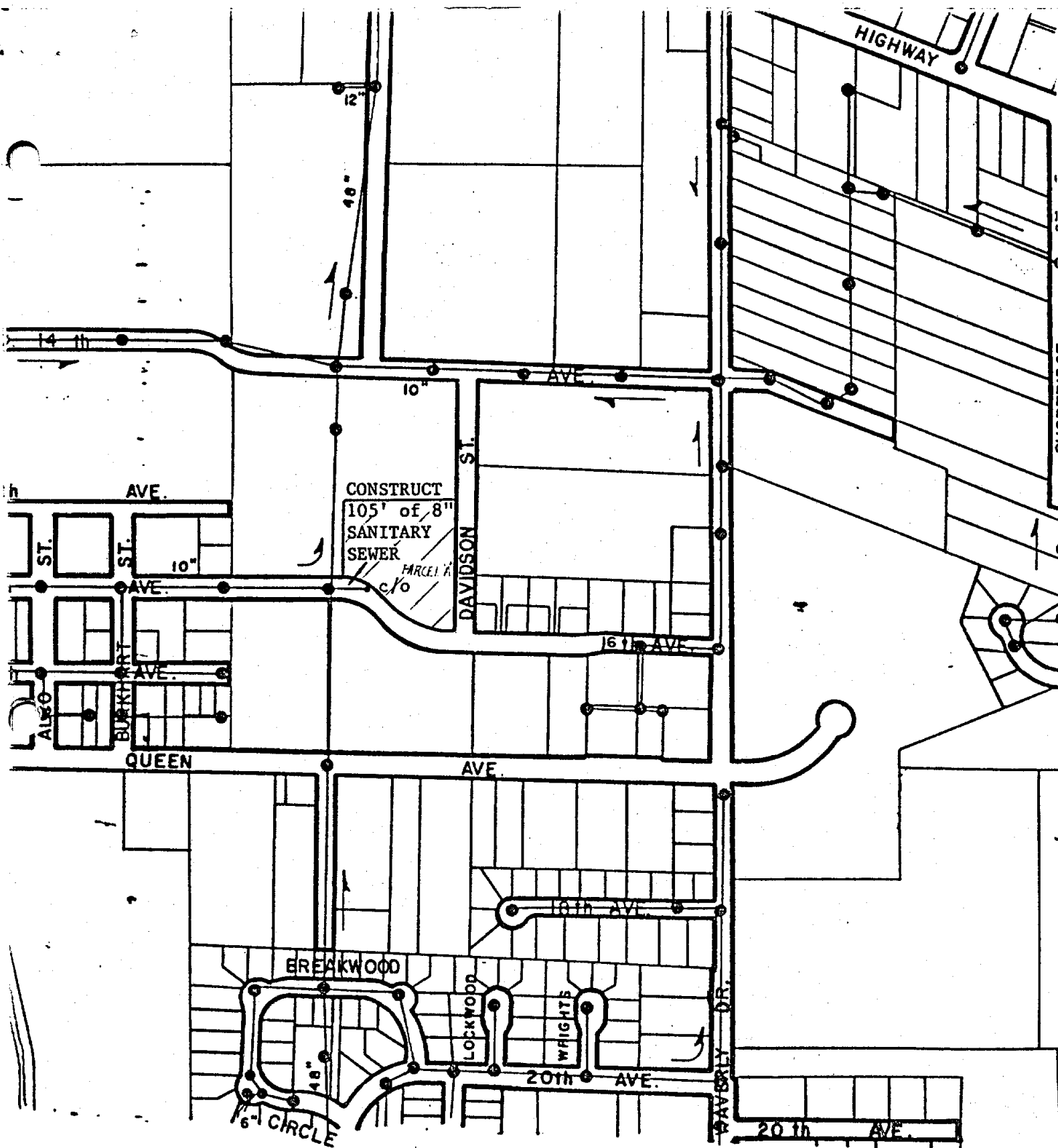

PUBLIC WORKS DEPARTMENT  
 ENGINEERING/WASTEWATER DIVISION  
 SS-83-4 ALBANY RESIDENTIAL CENTER  
 SANITARY SEWER